



datasheet

DM-date

06/2021



characteristics

The DM-date is a true digital date stamp for polymer shaping and reshaping processes. It is mounted directly inside the mold tool and connected to a DM-controller, located at the edge of the mold. Three versions are available with selectable resolution of the date/time or with a single piece serial numbering capabilities.



typical installation

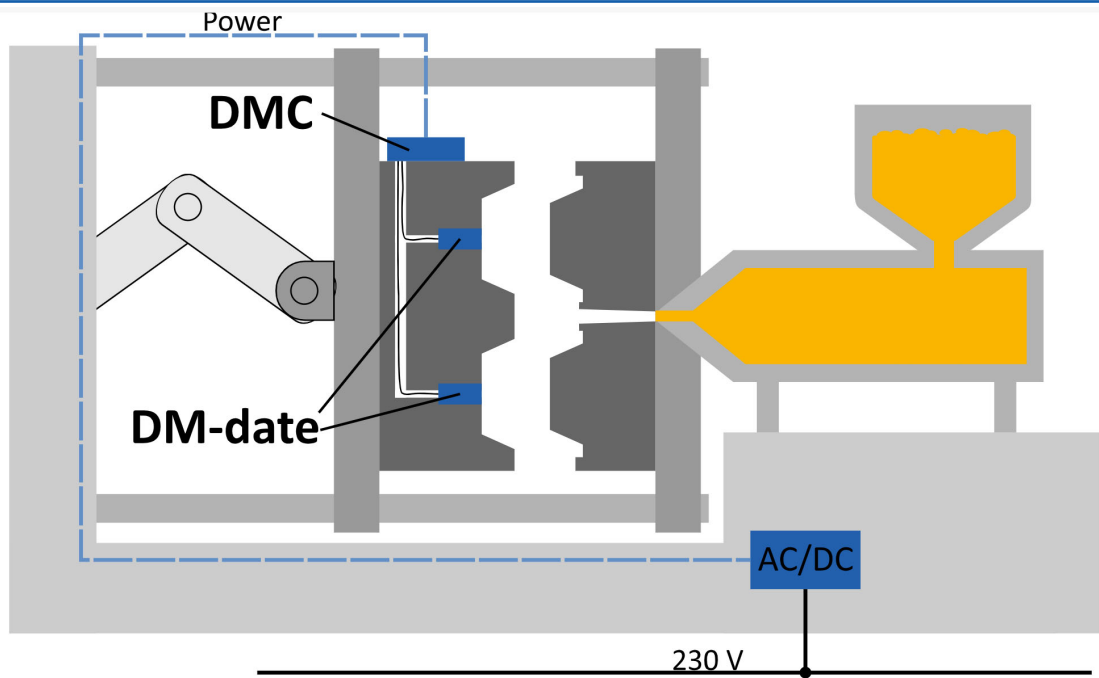

drawing

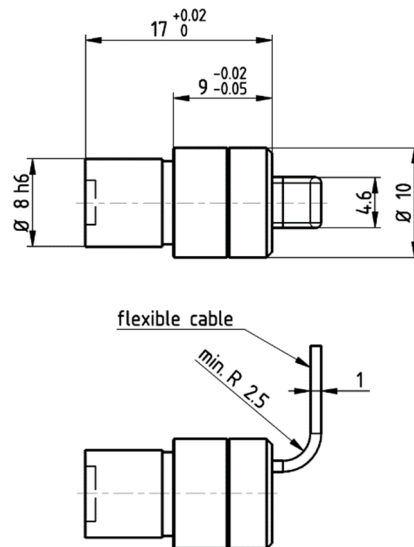

product image

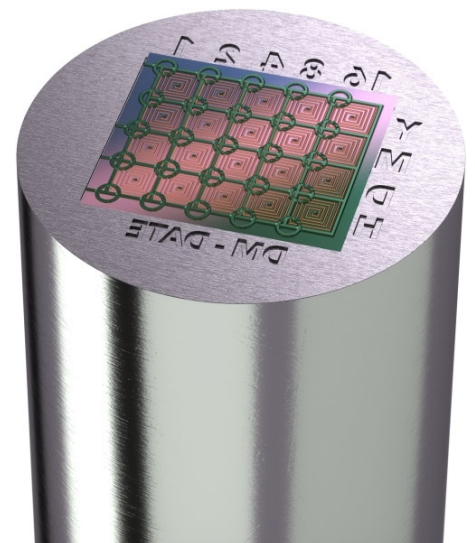

DynamicMold® inserts have a small cable that connects to the DM controller that supplies the time/date pattern or a serial number. A cut-out form can be delivered for construction and assembly purposes.

versions

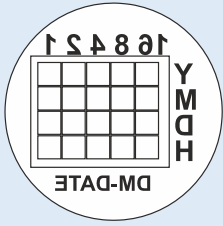
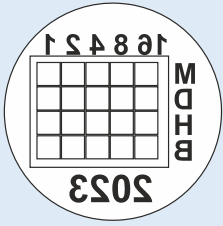
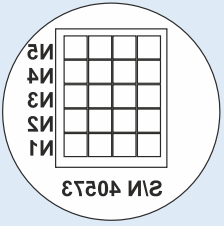
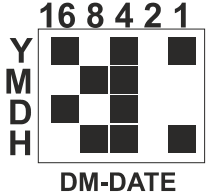
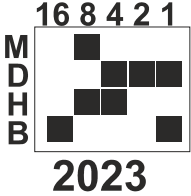
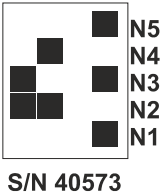
	DM-date-h	DM-date-m	DM-mate
mold insert front surface			
precision	1 hour	2 minutes	single piece
value range	2000-01-01 00:00 2031-12-31 23:00	20XX-01-01 00:00 20XX-12-31 23:58	00001h = 1 FFFFFh = 1'048'575
sample imprint			
sample data	2021-12-20 13:00	2023-08-07 12:34	149C1h = 84'417 stamp s/n 40573

technical data

version	DM-date-h DM-date-m DM-mate
suitable polymers	amorphous, non-filled polymers others on request
suitable process	injection molding blow molding thermo forming
suitable machines	machine independent
trigger	self-triggering (internal temperature sensor)
max. mold temperature	150°C at site of DM insert position
max. molding material temperature	up to 400°C
min. cycle time	1 sec
format date / time / serial	binary
cable length [mm]	500
controller dimension [mm]	165 x 100 x 35
power	24V, 100W peak

disclaimer

ALL PRODUCTS, PRODUCT SPECIFICATIONS AND DATA ARE SUBJECT TO CHANGE WITHOUT PRIOR NOTICE. WE STEADILY IMPROVE RELIABILITY, FUNCTION AND DESIGN OF OUR PRODUCTS AND SERVICES.